

Talking Drawings



I truly believe that the art of drawing, gives the designer a deeper understanding of their work.

I choose to draw, and through it to design.

No matter the challenge, my pencil never stops.

The Mighty Pencil

I am trained in **technical drawing**.
Which means, if computers don't work one day, I still do!

The pencil is my first weapon of choice.

There is a legend, that every single Palomino Blackwing pencil is handcrafted and inspected before being released. Ever since I heard that, I knew I wanted to do the same with my projects.

And I do, with every line, brush stroke, and file export...



KINGDOM DOWNTOWN

Masterplanning - Highlighted Project: Al Ahsa

KDT is a complex masterplanning project with multiple sites, set to rejuvenate areas across the country into contemporary destinations for the whole community to enjoy.

While working on this project, I learned to tackle multiple proposals at once, all in different stages of development, with different requirements.

Through simple sketches, collages, and 3d representations we were able to quickly communicate fast pacing ideas with our client.

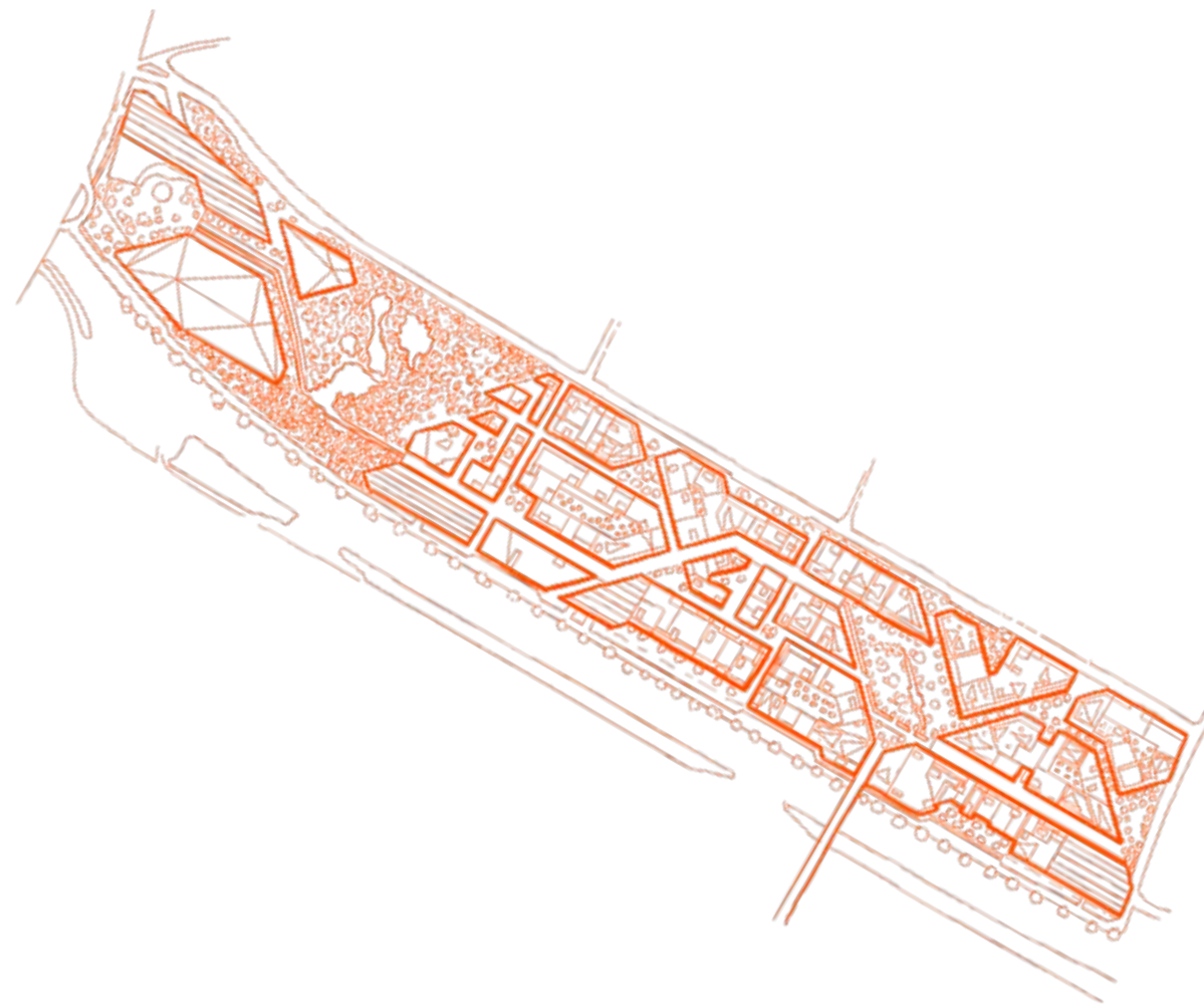

Being involved in so many projects at once proved to be a great opportunity to learn how to focus and tackle simultaneous deadlines, and speed up my design process.

‘Visions of a regenerative hustle and bustle’



Al Ahsa site - concept sketch for the Oasis Plaza

NEMO's TENTORIUM

Concept Architecture - Academic Project MArch

Nemo's Tentorium is a speculative floating mobile city, a self-sufficient community, designed as an alternative to land-based societies.

This is a project where I put my heart into from the first sketch, and where I had a clear idea of how I wanted to tackle it.

I am now glad that I followed my intuition, and did not give into the rumours that a full hand drawn portfolio was not achievable.

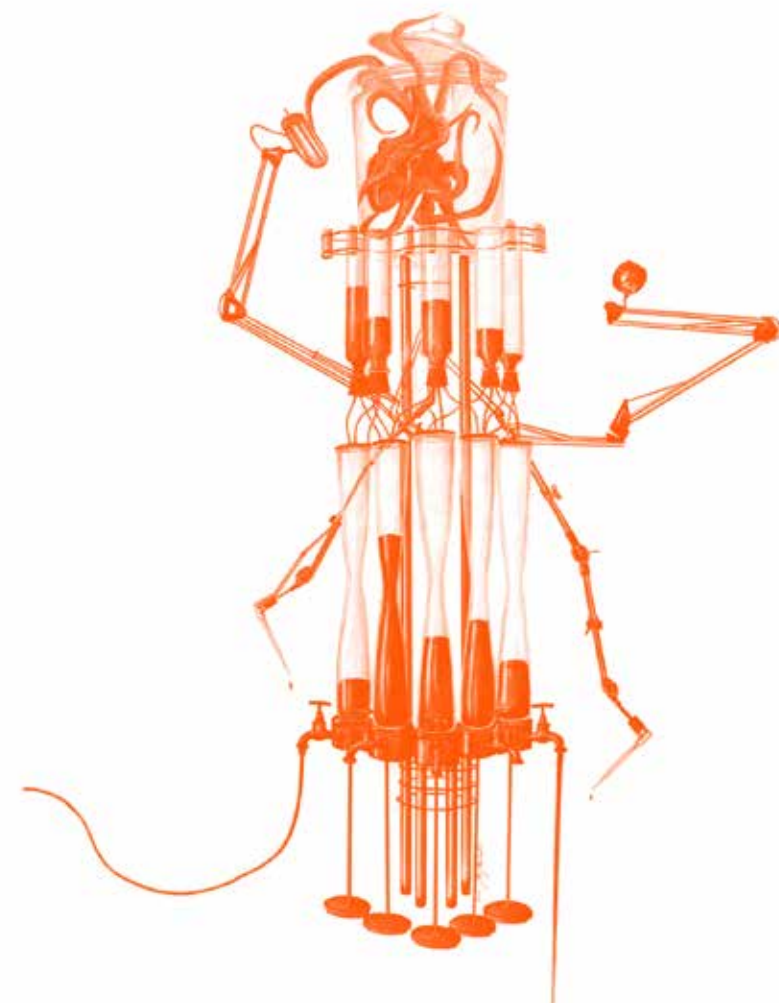

Finalist @ 2019 KRob AIA Architectural Delineation Competition

In the end, the entire portfolio was hand drawn, as planned, and due to its success I was able to curate a solo exhibition in London, and exhibited in New York, at Art OMI gallery alongside a multitude of talented architects from around the world.

'A place where my imagination can run wild'

Inspired by Jules Verne's character, Captain Nemo ('Twenty Thousand Leagues under the Sea'), a man with a deep love for the ocean and knowledge, the project is set to continue his extraordinary journey, which began within the pages of a 19th century book.

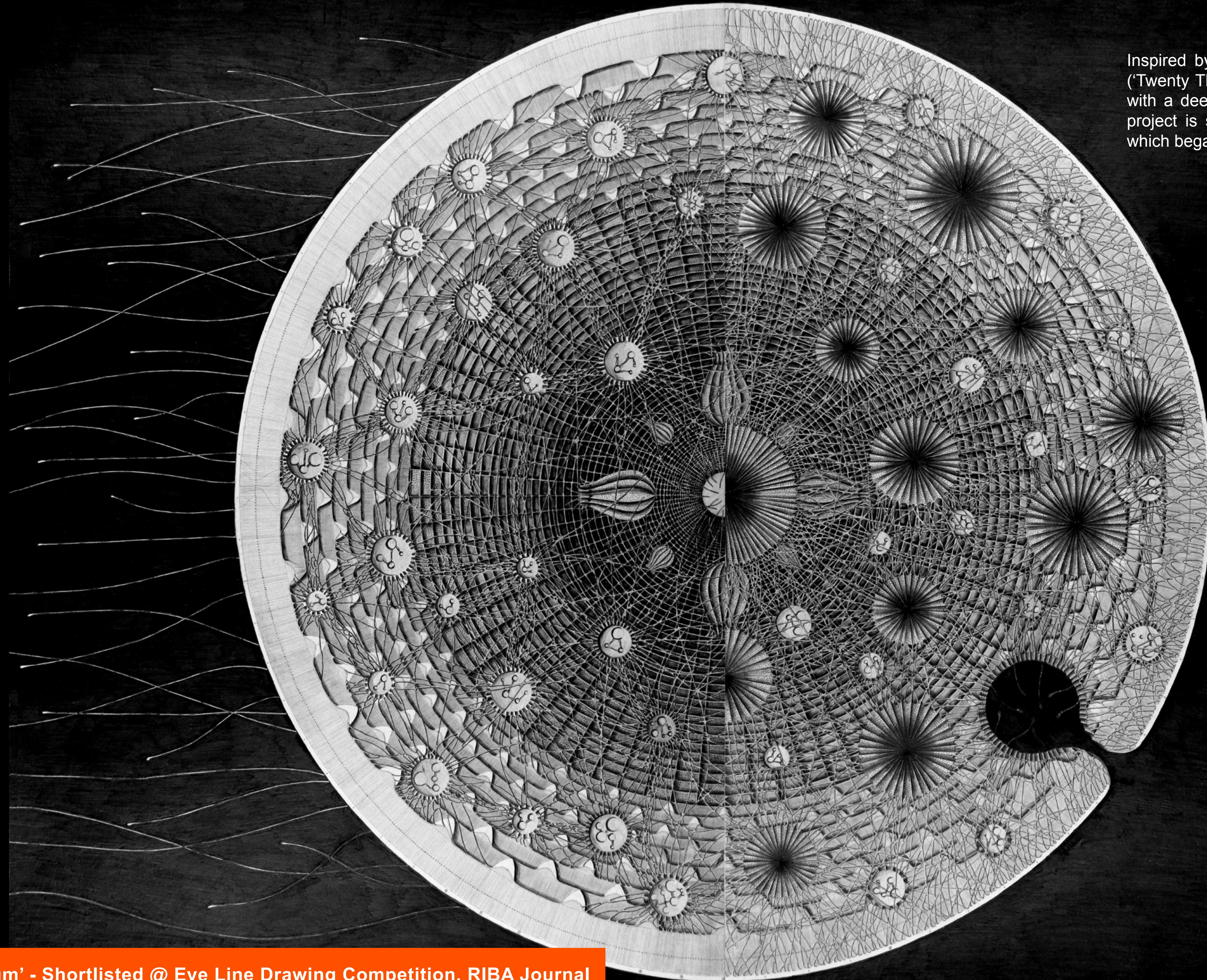



For The Sketchbook

I treat every project as an opportunity for greatness.

The process of starting something new is always exciting for me. Regardless of the stage, researching the brief I am given, and planning the strategy in my sketchbook feels like the start of a good competition.

And I plan to win!

The Wild Regent

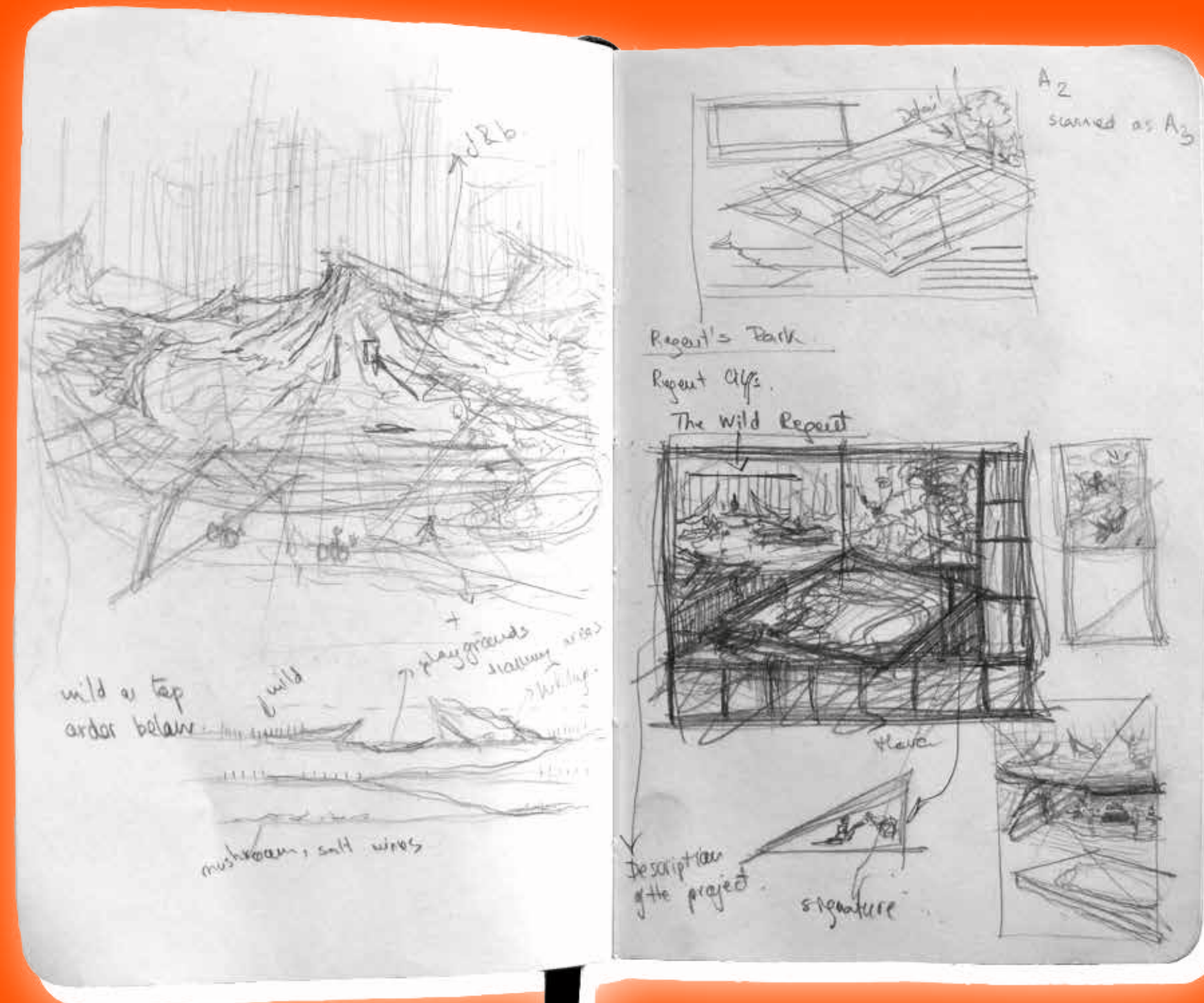

Developed for a competition organised by the London Society, the project aimed to awaken an inner wilderness in the city's dwellers.

I wanted to offer an 'out of the box' proposal that would focus exclusively on the natural elements of a park and the need to escape the busy city. I sketched the concept for it immediately after reading the brief, and a couple of days later...

'Envisioning an alternative future for city parks'



SOUTHAMPTON CRUISE TERMINAL

Transport + Commercial Design

The cruise terminal will be a carbon neutral development, with durable but flexible spaces designed to accommodate future changes in passenger & business needs and regulations.

During the bidding process, the team needed an attention grabbing proposal, and this is where I came in.

Due to a combination of quick sketchup modelling, pencil, and photoshop, the proposal was accepted with open arms, and we began working on the project immediately.

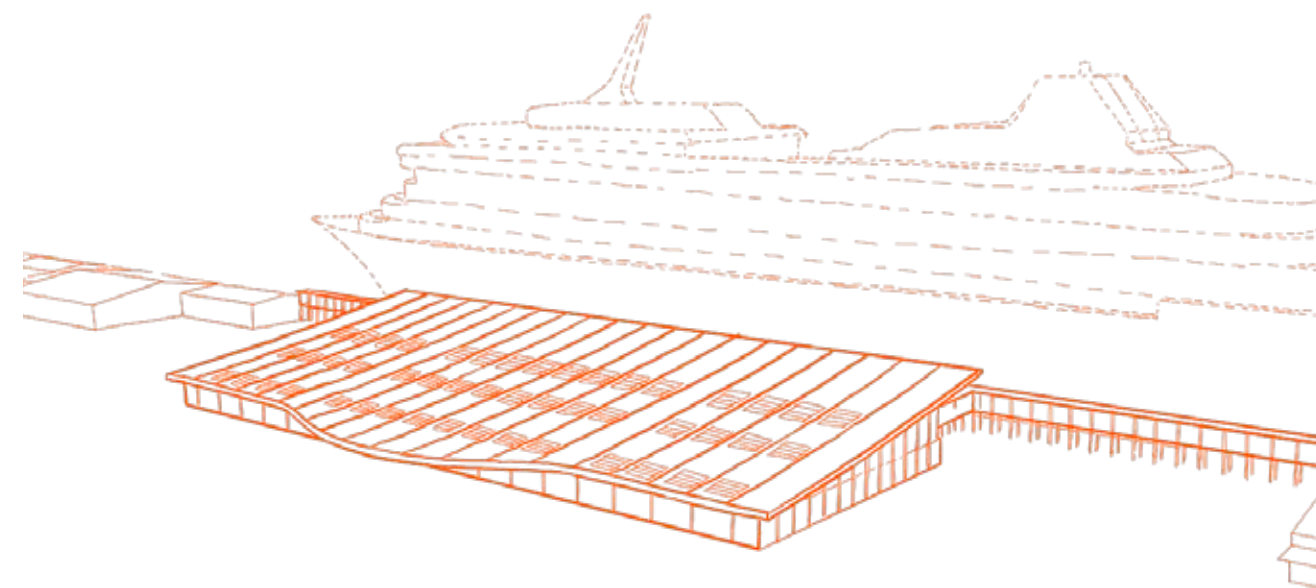

'Plenty of fish in the sea, now with more humans!'

I participated in the early stages of the project, and was responsible for aiding the building design with illustrative drawings that were included in the bid proposal.

Currently the project is set to begin construction!

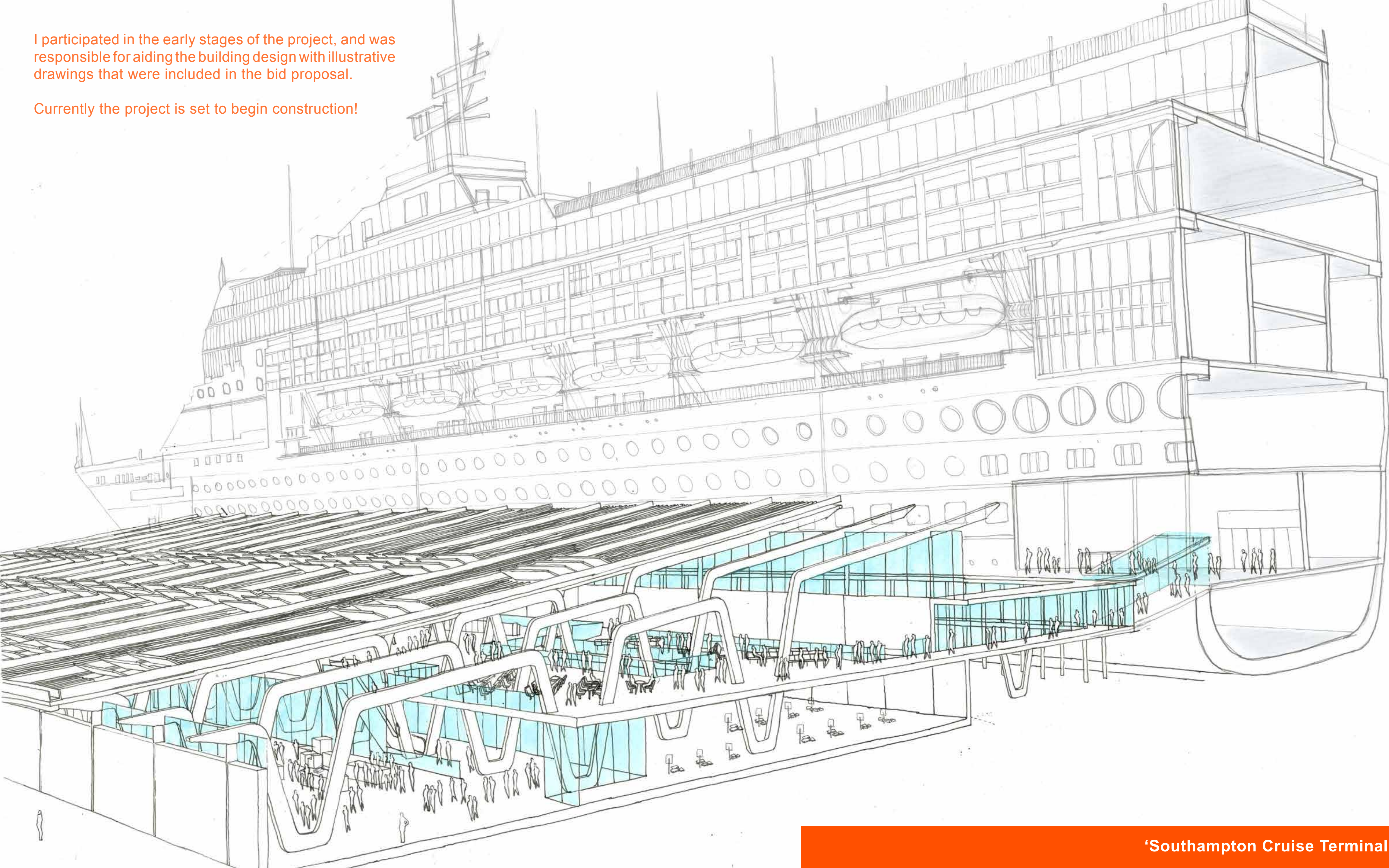

'Southampton Cruise Terminal' - Winning sketch

Paper. Screen. Skill

We live in a technology driven society, and our design software is innovated each day.

I have had countless discussions regarding where hand-drawings fit into the 'new world'.

I believe that art (drawing, sketching etc) evolves alongside everything else.

And because...

Drawing is not a lost art!

...is exactly why it has been so easy for me to switch between paper and screen.



*'Luxurious
digital details'*

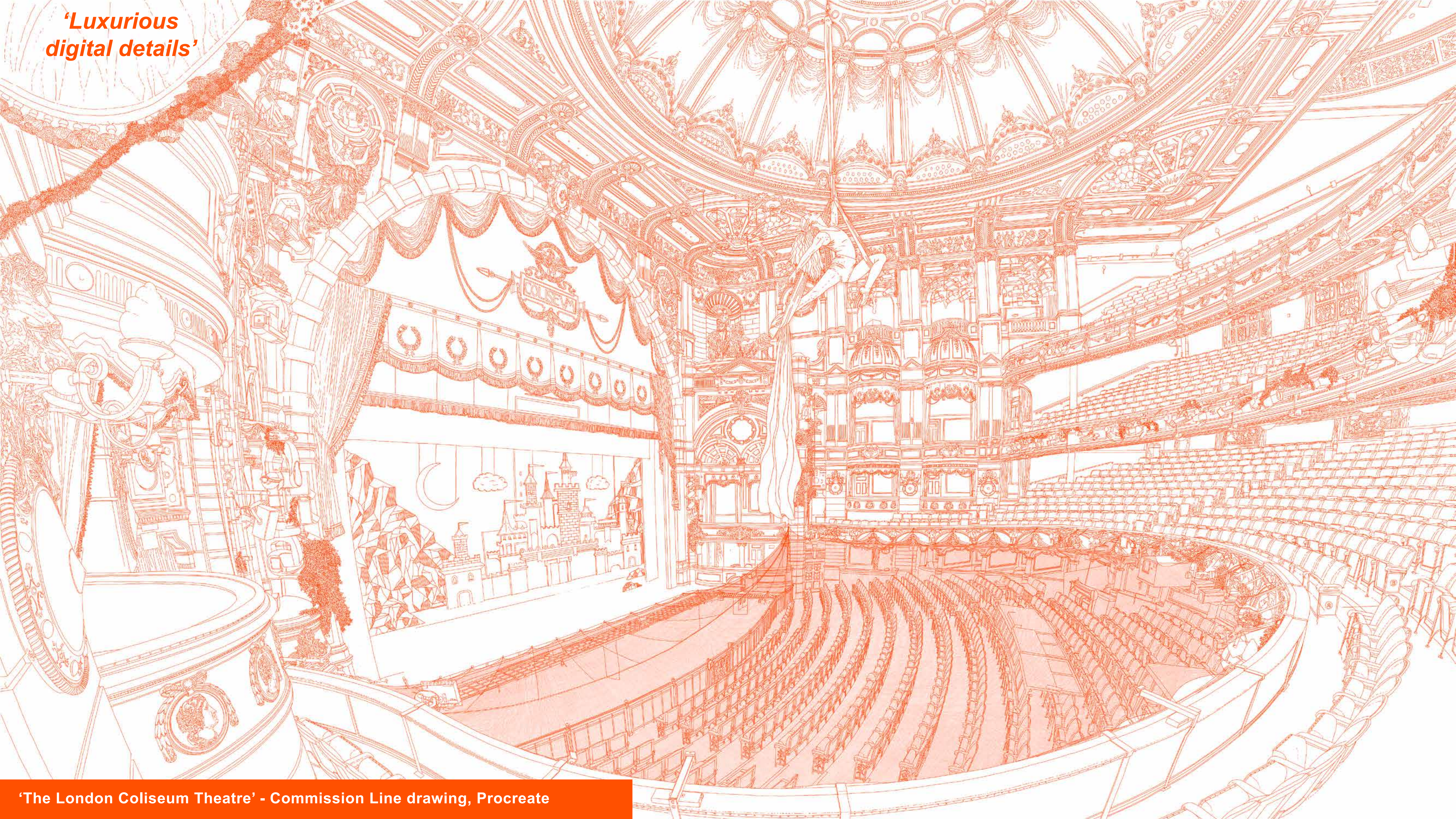

'The London Coliseum Theatre' - Commission Line drawing, Procreate

GATEWAY COLLEGE

Mixed Use, Education + Residential Design

The project seeks to redevelop an established community with a contemporary educational core, affordable residential apartments, and commercial amenities.

Gateway College (previously known as Hammersmith & Fulham College) proved to be a welcoming challenge, as I was thrown into the deep end very early on. I helped develop strategies to determine the optimal residential design as well as a certain ratio of apartment types, while taking into consideration the site constraints, as well as considering the needs of the neighbourhood.

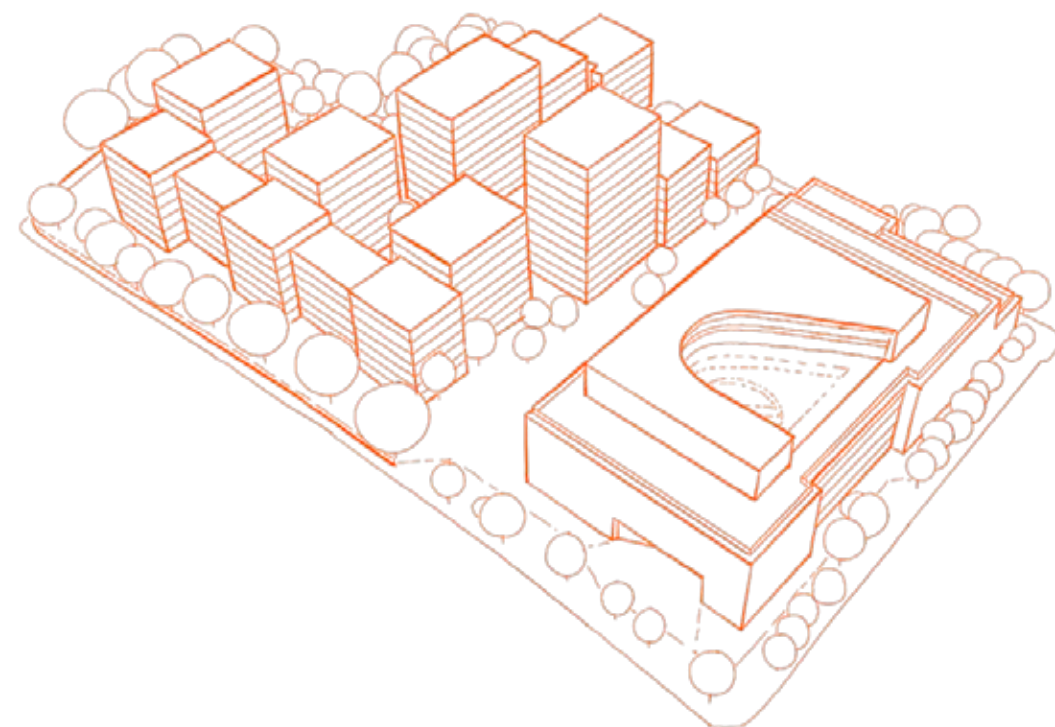

After hundreds of Revit design options and recalculations it was amazing to see how much more we could offer the community, once the old college footprint was removed.

'Old building out, new buildings in!'

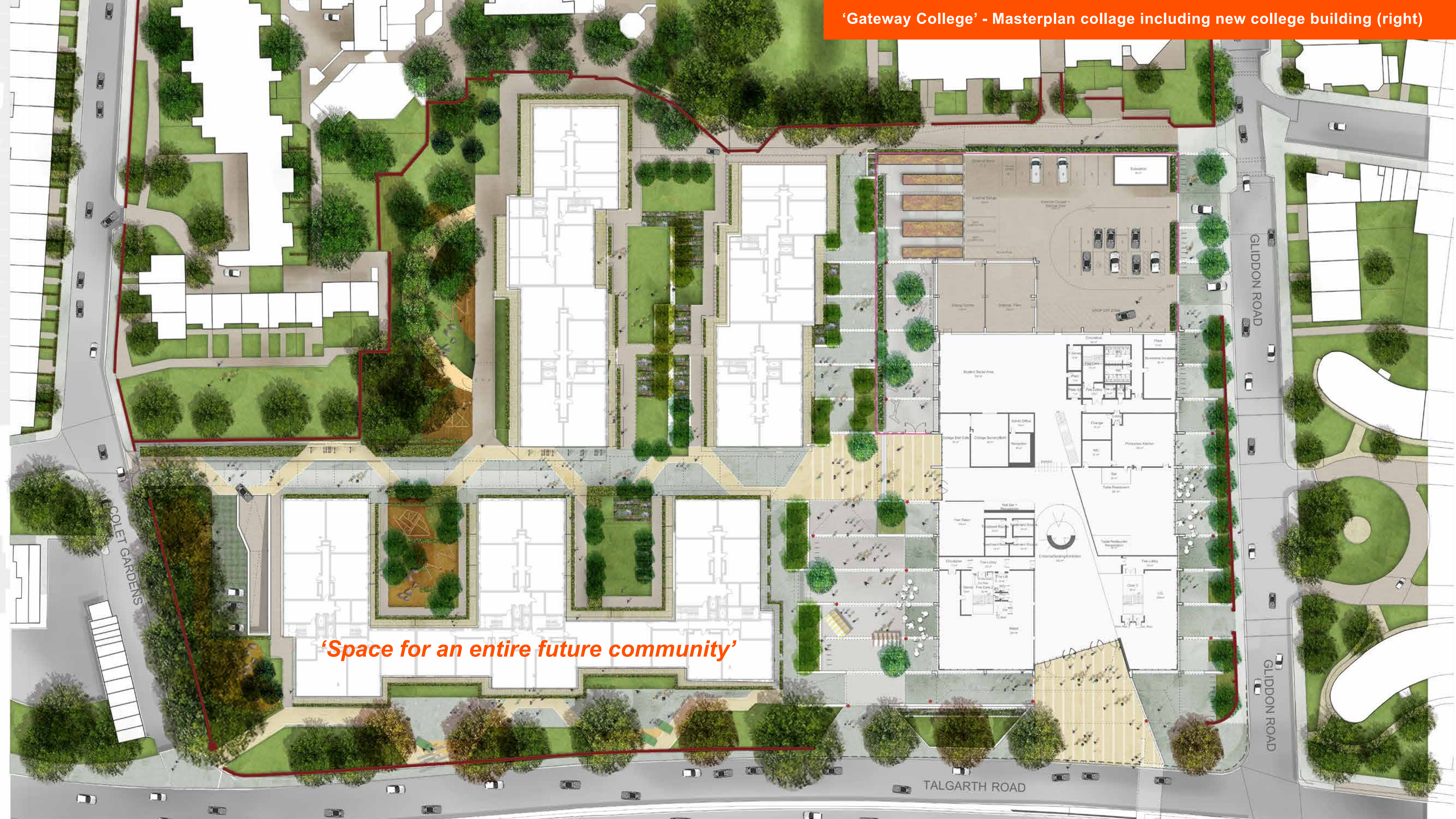

'Space for an entire future community'

COLET GARDENS

GLIDDON ROAD

GLIDDON ROAD

TALGARTH ROAD



'Balance of rhythmic geometries'

Small Mistake - Big Lesson

Complete appreciation for the eraser and the 'undo' button!

For some reason, I used to think of these as 'mistake' removers, and dreaded using them, as if I didn't that would make my work better.

Little mistakes, and improvements are completely necessary in a project, and very rarely do we, as designers get things right from the first sketch.

It's why we have so many files labelled 'draft'.

Some of the most important lessons I have gotten in my career so far, have come from mistakes.

However, that led to fast progress. It led to me evolving my skills, my focus and my drive.



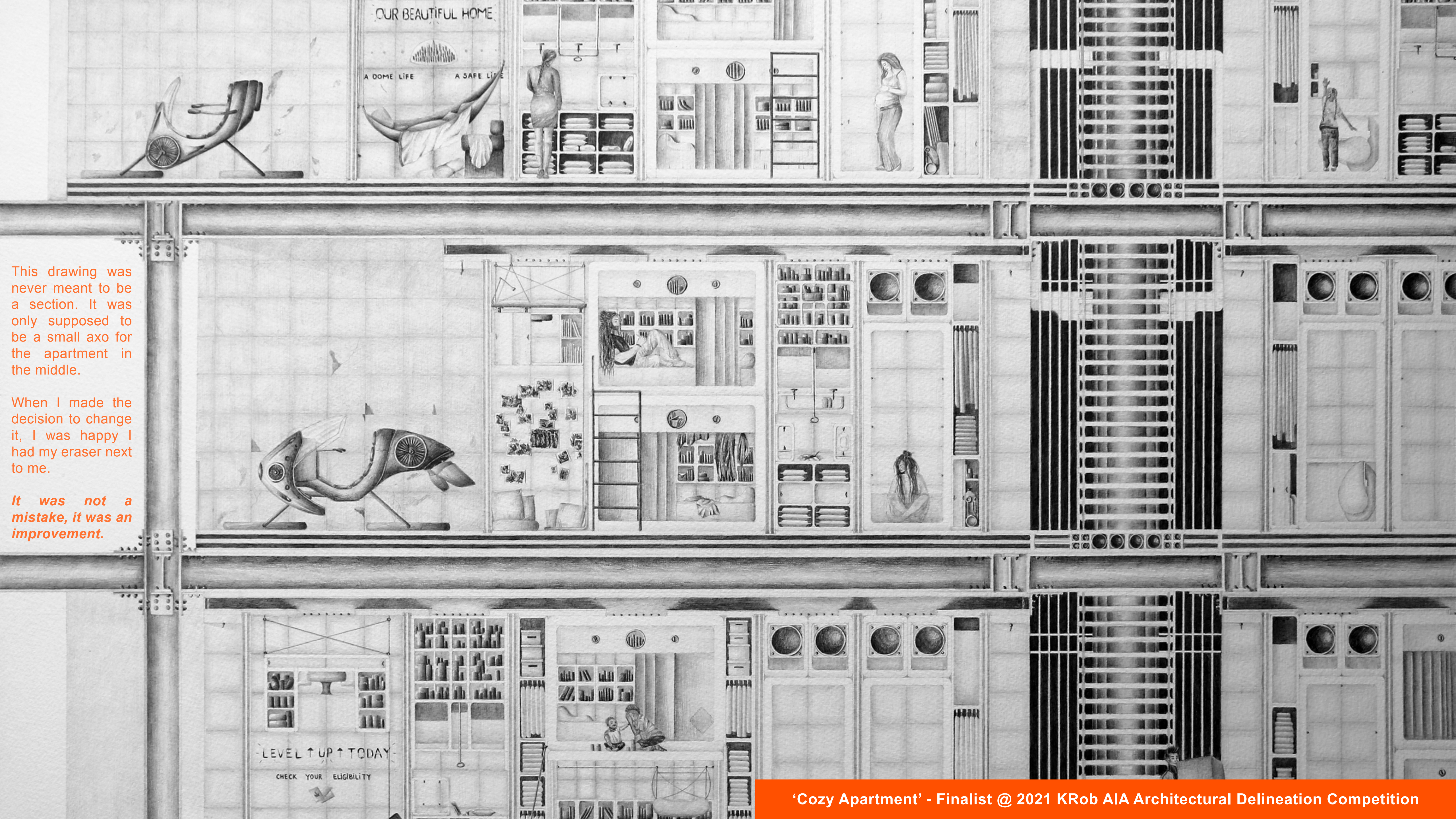

OUR BEAUTIFUL HOME

A DOME LIFE A SAFE LIFE

LEVEL UP TODAY

CHECK YOUR ELIGIBILITY

This drawing was never meant to be a section. It was only supposed to be a small axo for the apartment in the middle.

When I made the decision to change it, I was happy I had my eraser next to me.

It was not a mistake, it was an improvement.

SKY INNOVATION CENTRE

Office Design

The Innovation Centre is a new office building for Sky employees, designed to fit in the overall masterplan, and to provide full business transparency and collaboration between the teams across the campus.

Working on this project was an extraordinary journey.

I was involved from the initial stages, and as the project advanced, and the team grew, the building started taking its final shape, and soon enough all the retouches, revisions and modifications were replaced by the best version of our initial design.

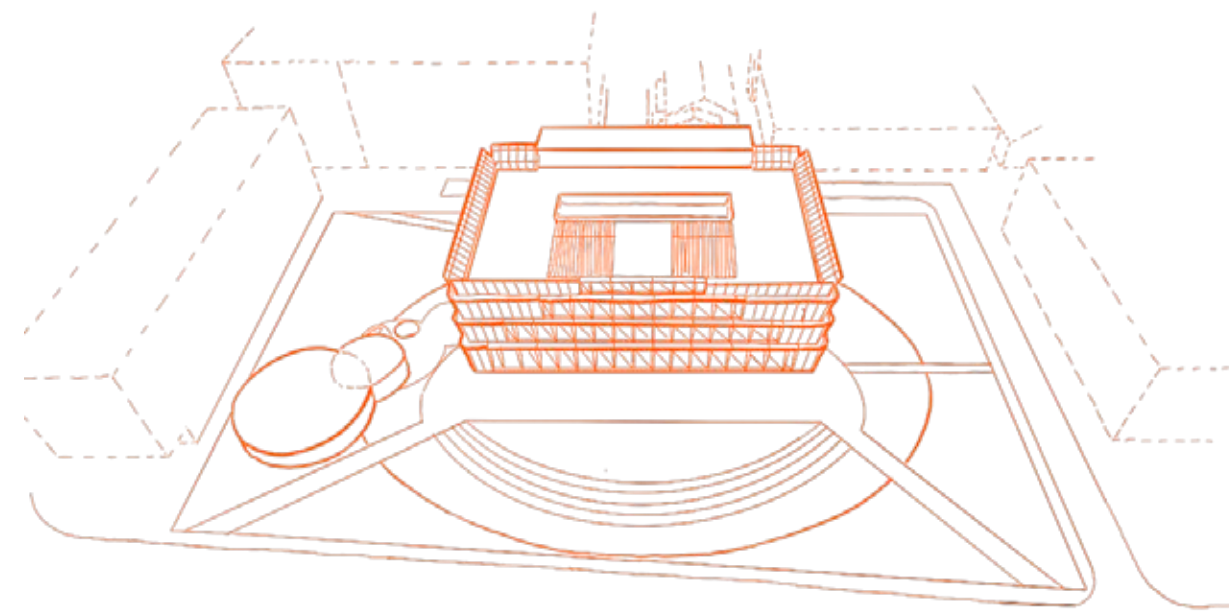

The new building promotes work well-being, and is sustainable, reliable, and simple in its operation. And best of all, the users love it!

‘Blurring the line between building and public realm’

'Vision sketch gets final approval!'

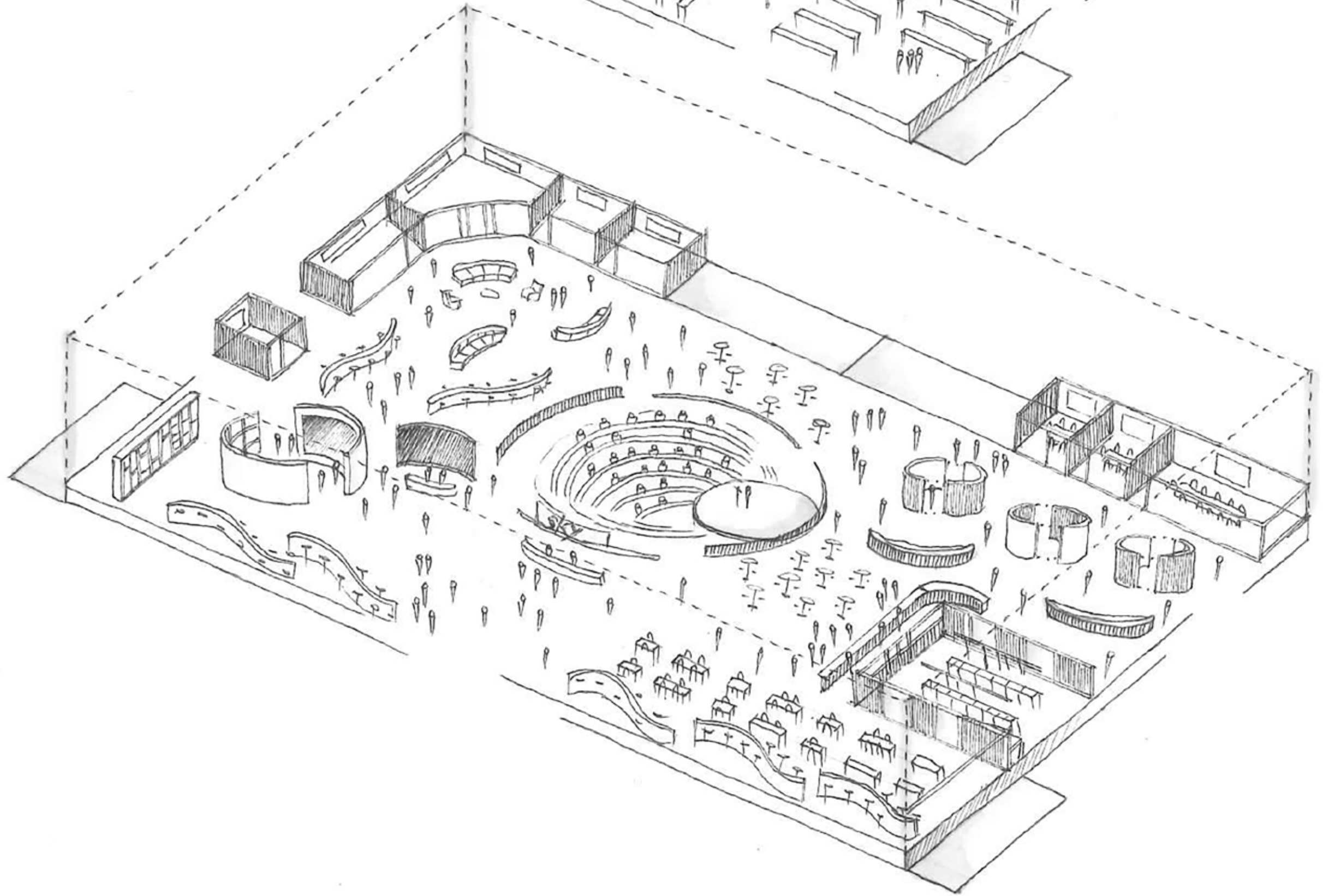
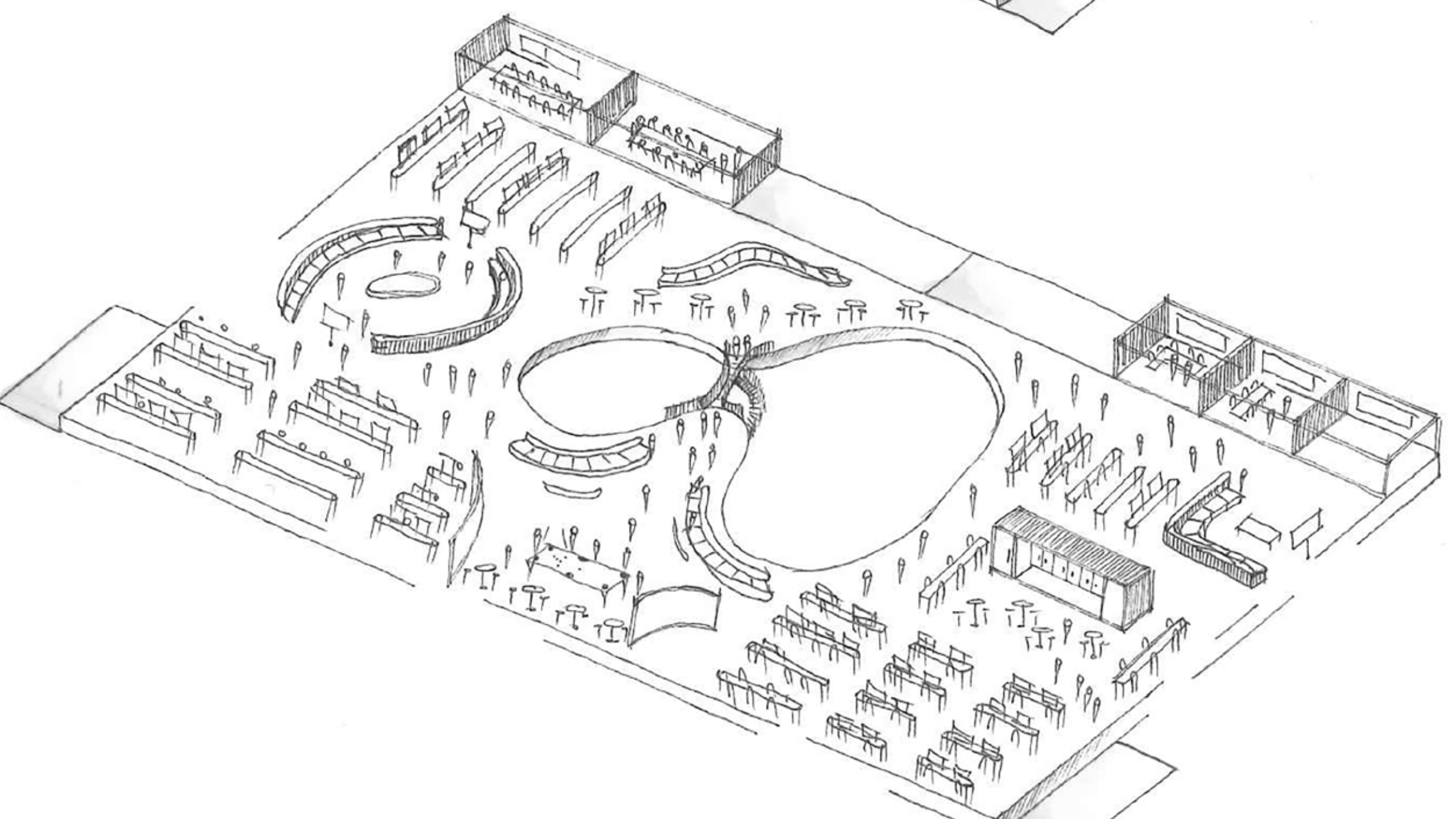
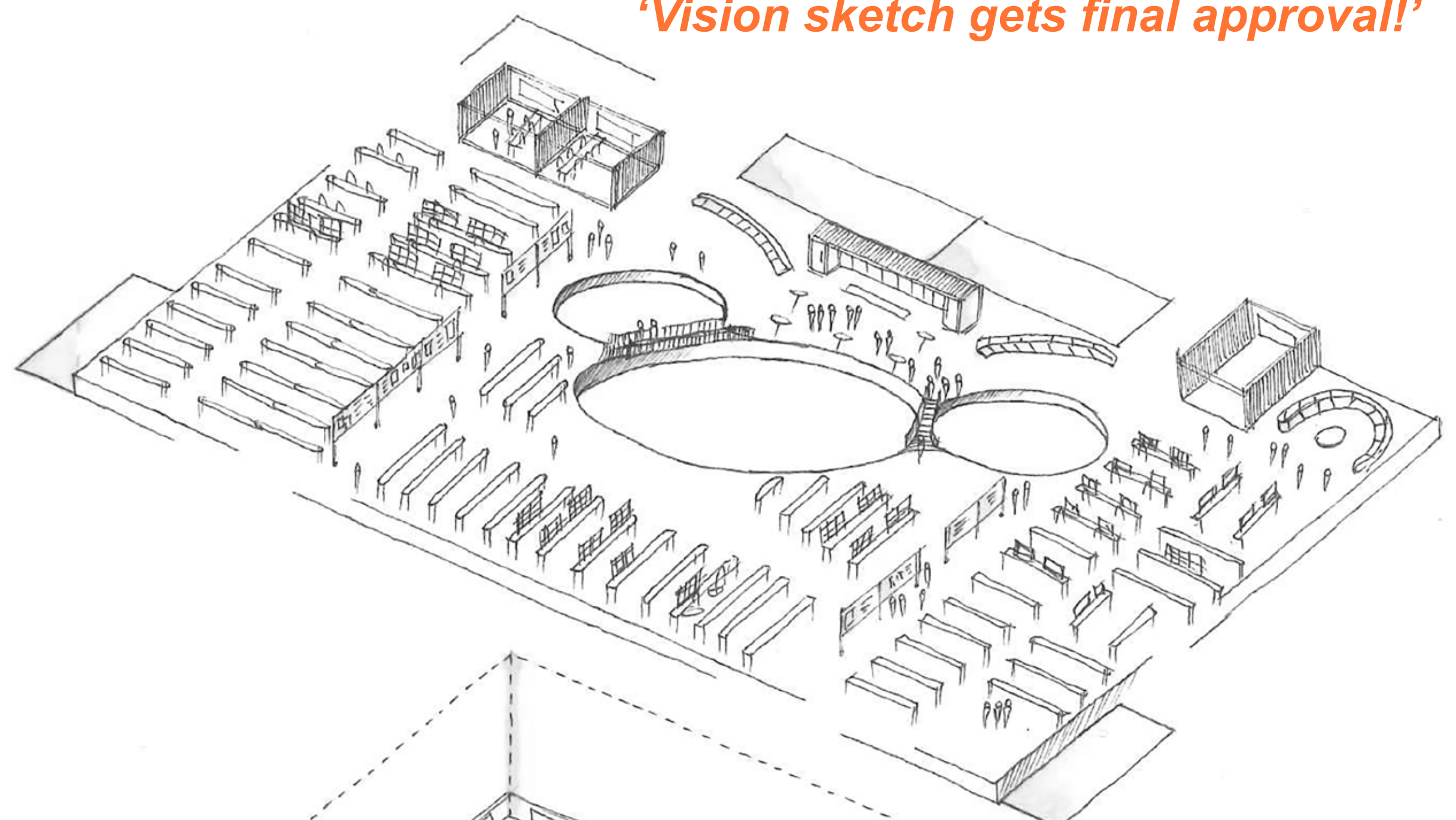
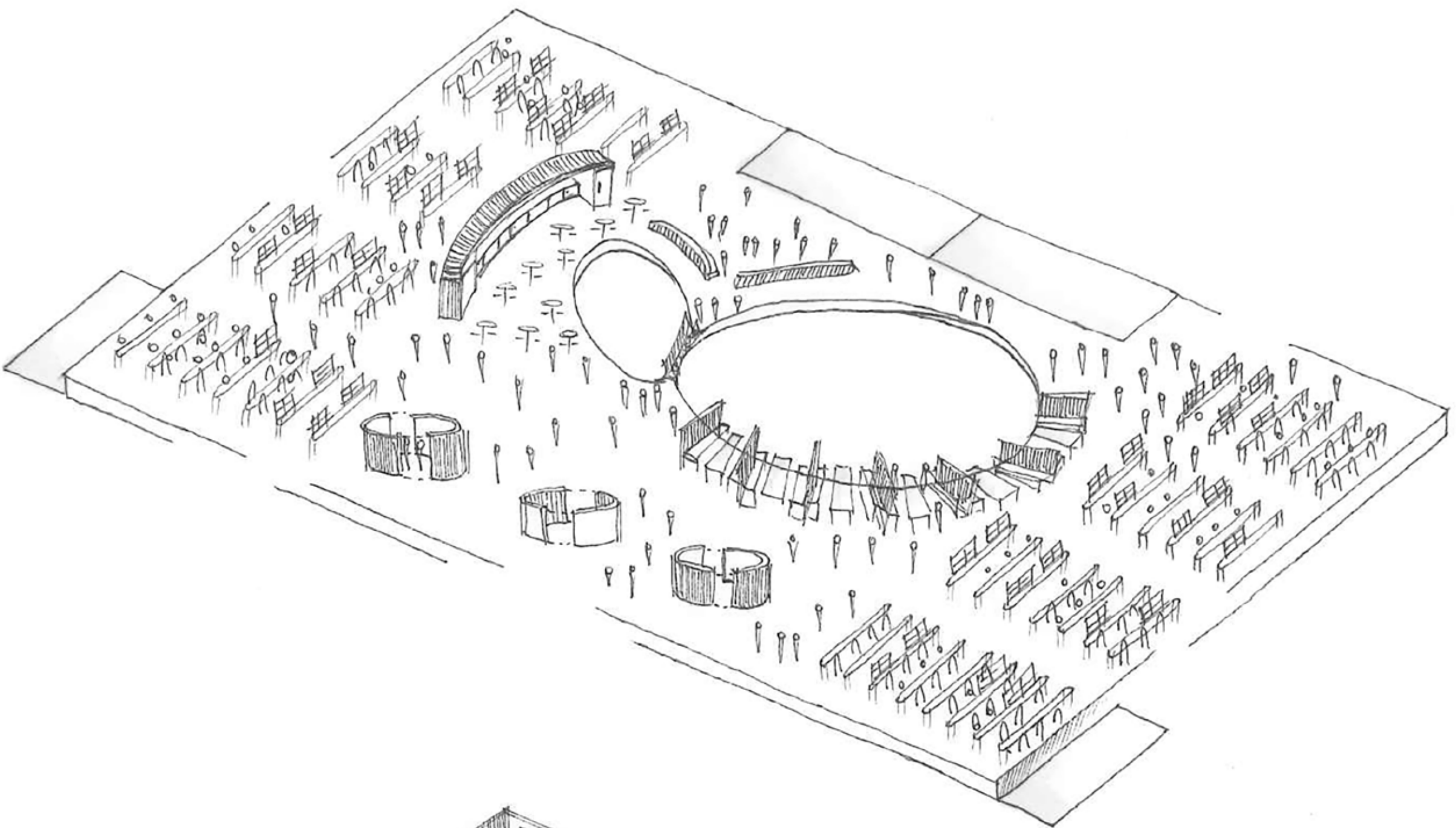

'Isometric floorplans for Sky Innovation Centre' - workplace arrangement option



All Forms and Mediums

I am always looking for new mediums to express my work and ideas.

I remember how watercolour was the first step in this direction. Having drawn all my life with the precision of the pencil, pen and mouse, it felt unnatural to give up all that control, and use a medium that would almost have a mind of its own.

Giving up control, turns out, was the way to conquer this particular new medium.

Always up for a new challenge!

PEARL DELTA

Abstract Masterplanning Watercolour Painting

The first of a series of abstract masterplan paintings designed to represent different city planning geometries.

The Pearl Delta is a cluster based city, camouflaged by the aquatic environment surrounding it.

I wanted the final work to be a hybrid between abstract painting, and the terrain cad drawings that I do for overly contoured sites.

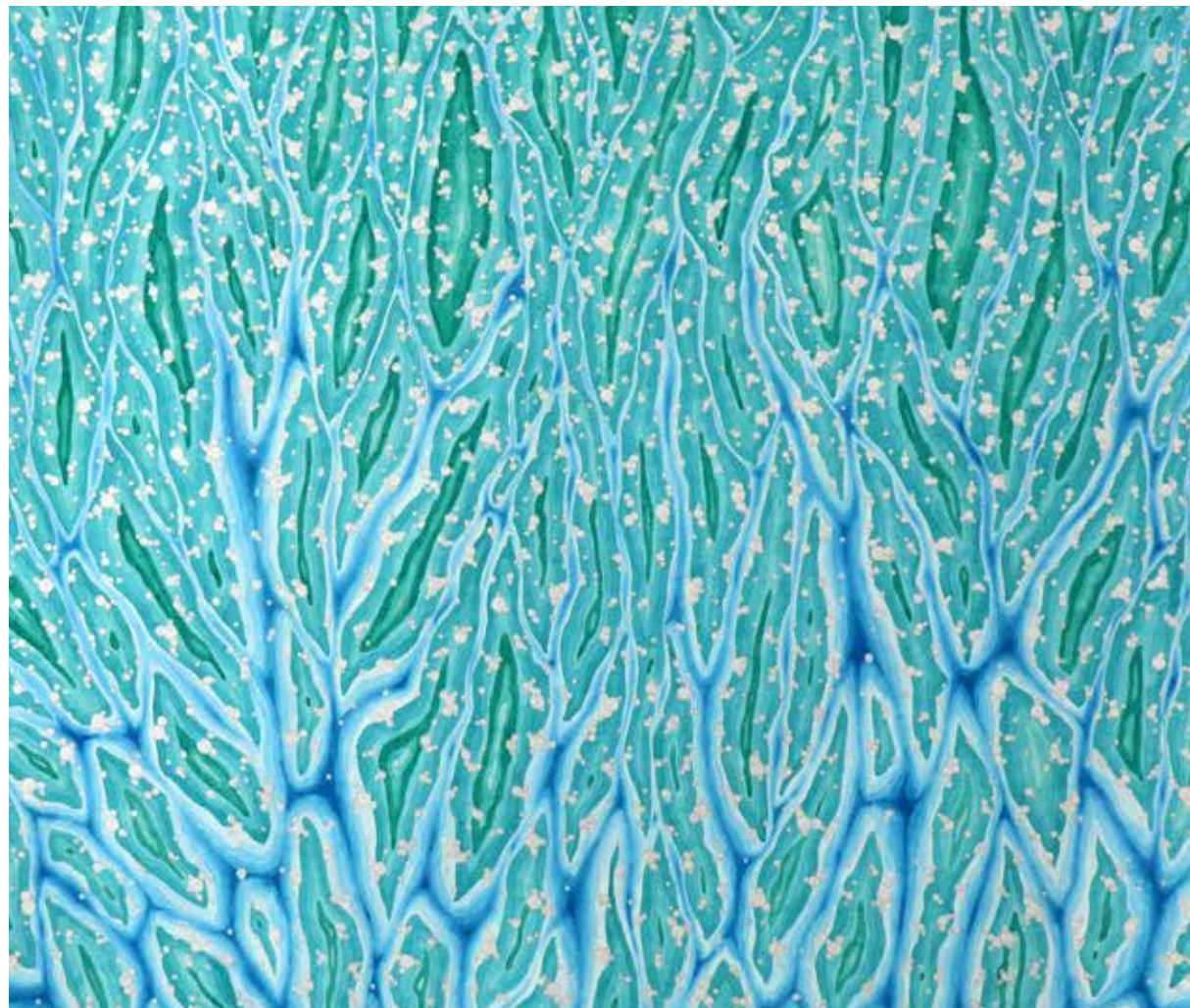

Finalist @Art Room Competition 2021

'Just another Blue Masterplan'

1 RUE BONAPARTE

Interior Design & Architecture - Redevelopment

A refurbishment project that was approached in a wider context taking into account the extended site. The context played a crucial part, as the apartment is part of a prestigious parisian area with a strong artistic character.

1 Rue Bonaparte is a high end residential project in the heart of Paris, France, opposite the Louvre Museum.

Due to the historically rich and diverse past a respectful approach was needed, as it included working with materials such as 300 year old wood, and exquisite masonry.

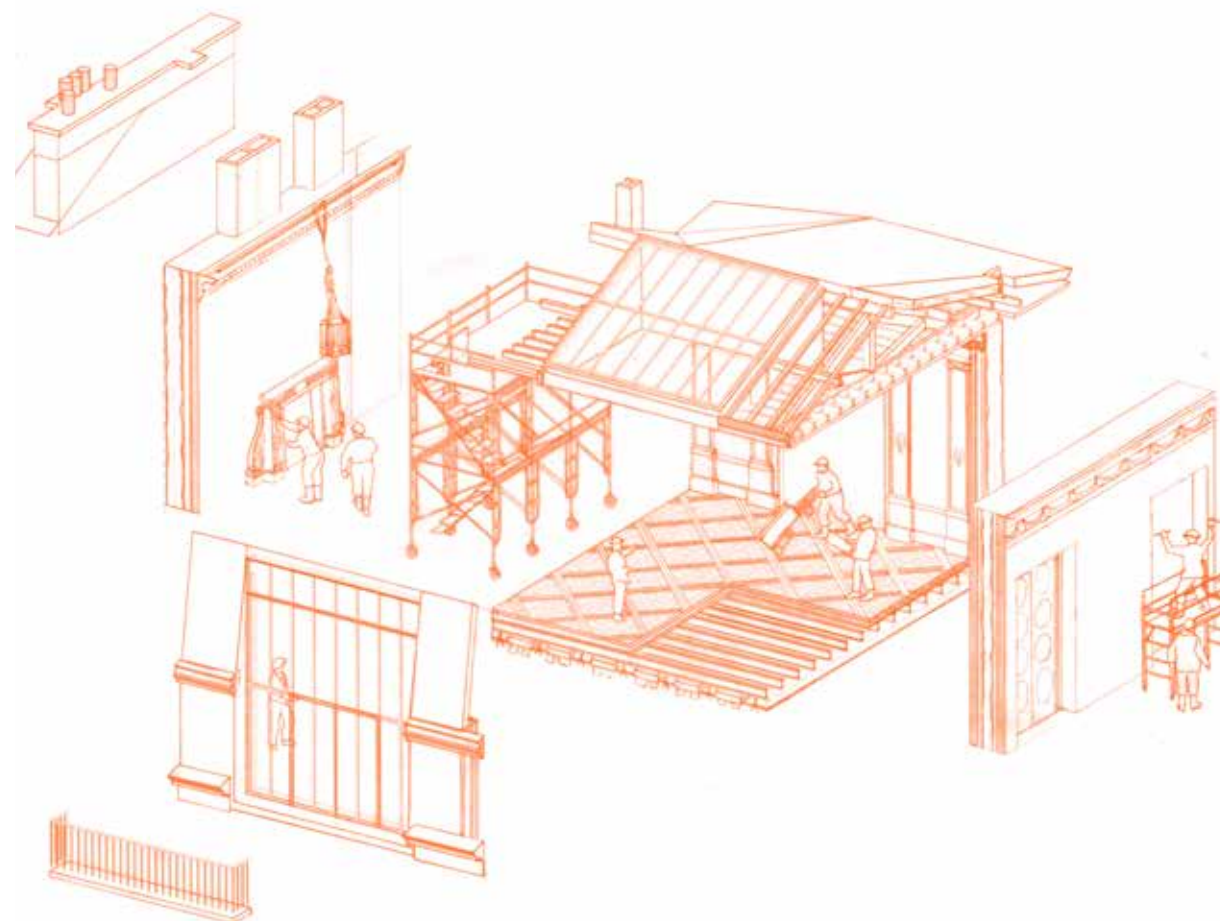

I was given full creative control of the architectural representation of the project, which allowed me to fully immerse myself in the project, and discover the French history that is ingrained in the craftsmanship of each room.

'An ode to the city's artistic heritage'

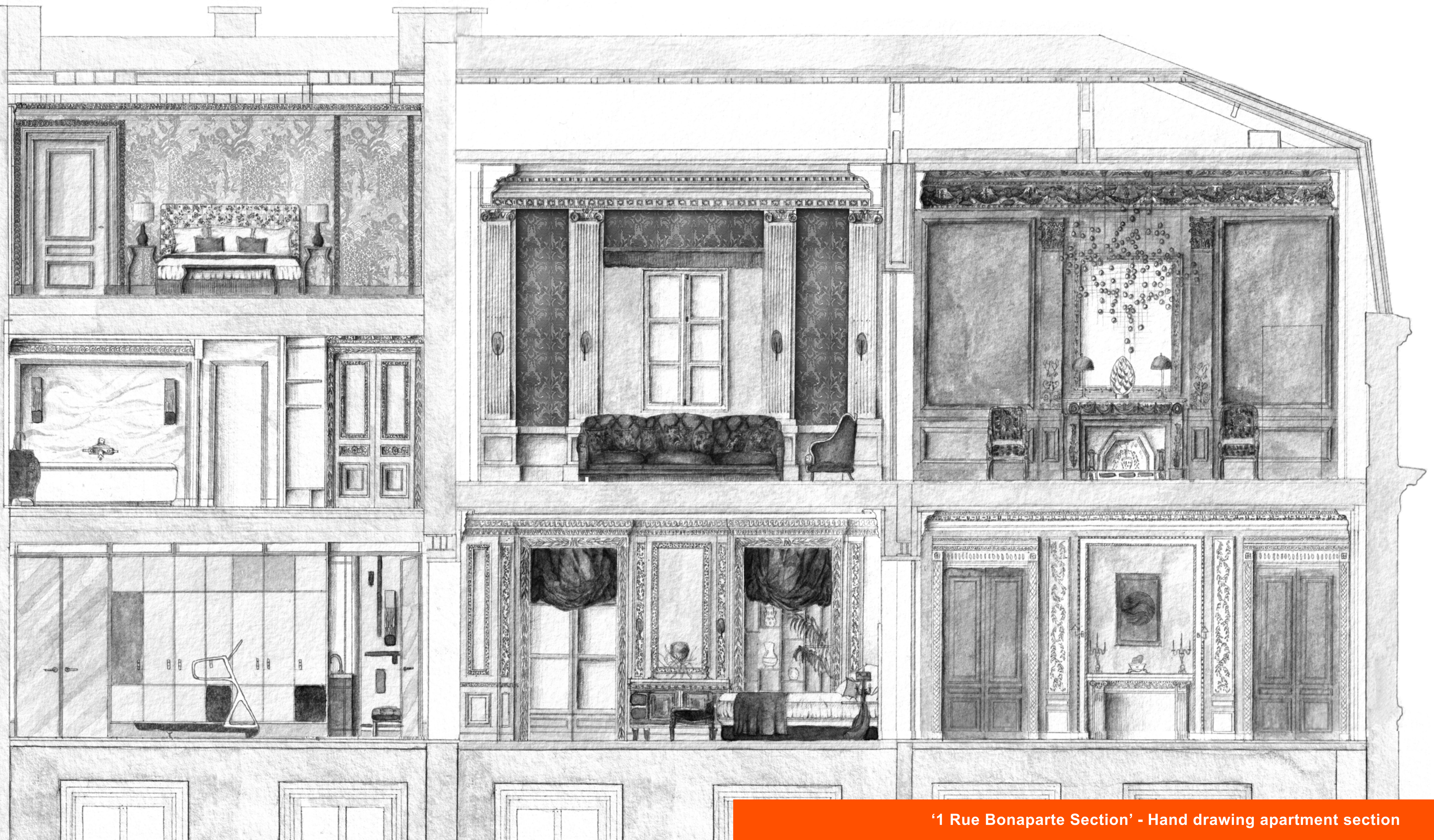

'1 Rue Bonaparte Section' - Hand drawing apartment section

The Architect



A personal project I have been developing for the last couple of years has been a graphic novel full of pencil drawings and digital sketches. Through this experience, I had a chance to learn more about narrative and storytelling.

'The Architect' explores an alternative futuristic view of a world, where humanity has divided into nature or technology driven communities, both clinging onto a past they can never return to.



Ready for my next adventure



Iza Iacinschi

contact@iza-iacinschi.com